

PHILIPS

NORELCO

Power
Hair Clipper



QC5055

Rechargeable
Cordless/Cord

Register your product and get support at
www.philips.com/norelco

IMPORTANT SAFETY INSTRUCTIONS

When using an electrical appliance, basic safety precautions should always be followed, including the following:

Read all instructions before using this appliance.

DANGER

To reduce the risk of electric shock:

1. Do not reach for a clipper that has fallen into water. Unplug immediately.
2. Use clipper only in dry condition. Do not use while bathing or in a shower.
3. Do not submerge clipper in water.
4. Do not place or store clipper where it can fall or be pulled into a tub or sink. Do not place in or drop into water or other liquid.
5. Always unplug this clipper from the electrical outlet immediately after using, except when clipper is (re)charging.
6. Unplug clipper before cleaning.

WARNING

To reduce the risk of burns, fire, electric shock or injury to persons:

1. Close supervision is necessary when this appliance is used by, on, or near children or invalids.
2. Use this clipper for its intended household use as described in this manual. Do not use attachments not recommended by Philips Electronics North America Corporation.
3. Never operate this clipper if it has a damaged cord or plug, if it is not working properly, if it has been dropped, damaged, or dropped into water. For assistance call 1-800-243-3050.
4. Do not rinse or immerse the clipper handle in water or any other liquid.
5. Keep the clipper, cord and any attachments away from heated surfaces.
6. Never drop or insert any object into any opening.
7. Do not operate, charge or plug in clipper outdoors or where aerosol (spray) products are being used or where oxygen is being administered.
8. Always check cutters, cutting unit and combs before using the clipper. Do not use the clipper if cutters, cutting unit or combs are damaged, as injury may occur.
9. Always attach plug to clipper first, then to outlet. To disconnect, turn on/off switch to "OFF" position, then remove plug from outlet.
10. To prevent possible damage to the cord, do not wrap cord around the clipper.
11. Never put clipper in direct sunlight or store at a temperature above 140°F.
12. This clipper is for use on human hair only. Do not use this clipper for any other purpose.
13. Always store your clipper, attachments and power plug in a moisture-free area. Make sure the cord is disconnected from the clipper.

SAVE THESE INSTRUCTIONS

IMPORTANT: The power plug contains a transformer. Do not cut off the power plug to replace it with another plug as this will cause a hazardous condition.

Registration

Congratulations on your purchase and welcome to Philips Norelco!

To fully benefit from the support that Philips Norelco offers, register your product at www.philips.com/norelco

Features

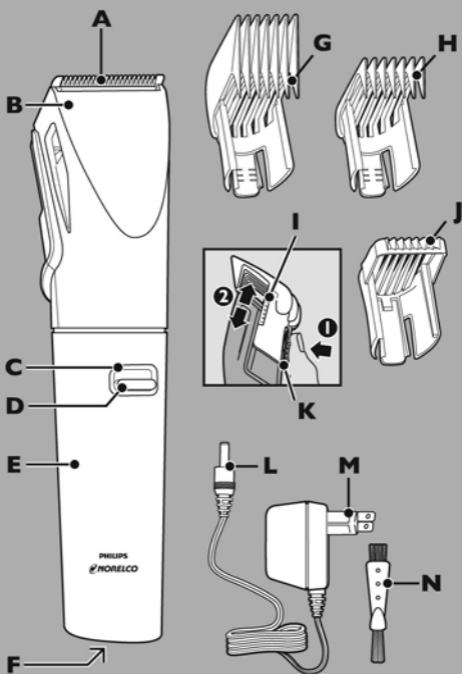

- A Stainless Steel Cutter Blades
 - B Clipping Attachment
 - C Charging Light
 - D On/Off Switch
 - E Handle
 - F Socket for Appliance Plug
 - G Large Comb
 - H Small Comb
 - I Setting Indicator
 - J Stubble Comb
 - K Hair Length Selector
 - L Appliance Plug
 - M Adapter
 - N Cleaning Brush
- Full Two-Year Warranty
45-Day Money-Back Guarantee

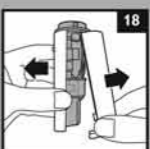
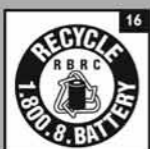
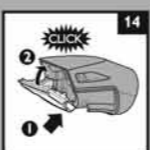
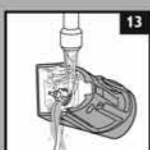
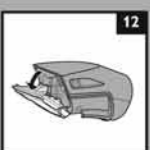
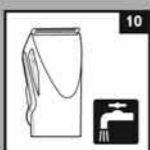
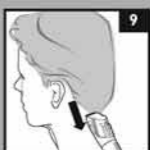
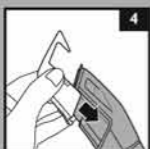
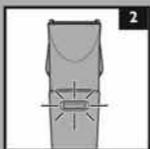

Put It To The Test

Like many new products, your Philips Norelco Power Hair Clipper may take a little getting used to. If you are using an electric Clipper for the first time, or if you've been using a different brand, take the time to acquaint yourself with your new Hair Clipper.

Your Hair Clipper features an extra strong motor and stainless steel cutter blades to comfortably clip even the toughest hair.

Throw your scissors away and put your new Hair Clipper to the test. We guarantee precise, professional results or Philips Norelco will refund you the full purchase price as long as the request is received within 45 days of purchase.

To Charge/Recharge

- ▶ Fully charge Clipper before using for the first time or after non-use for a long period of time.
- ▶ Battery performance is best if you recharge only when the battery is (almost) completely empty.
- ▶ Charging, recharging, or using Clipper at temperatures below 40°F or higher than 95°F adversely affects lifespan of the battery.
- ▶ Continuously recharging Clipper will reduce lifespan of battery.

- 1** Be certain Clipper is OFF.
- 2** Insert the appliance plug directly into the Clipper and plug the adapter into any 120VAC outlet (fig 1). Use only the cord provided.
- 3** After a few moments, the Charging Light on the appliance will light to indicate the Clipper is charging (fig. 2).

- ▶ It will take approximately 10 hours to fully charge the Clipper for a cordless clipping time of up to 35 minutes.

NOTE: After the Clipper is fully charged, the Charging Light will remain lit.

- 4** Disconnect the cord and unplug from electrical outlet.

Optimize the working life of the battery

- ▶ After the Clipper has been charged for the first time, do not recharge the Clipper between clipping sessions. Continue using it until the battery is completely empty.
- ▶ Do not charge for more than 24 hours.
- ▶ Do not keep cord permanently plugged in.
- ▶ Discharge/run down the battery completely twice a year by letting the motor run until it stops.
- ▶ If the Clipper hasn't been used for a long period of time, it must be recharged for a full 10 hours.

Corded Hair Clipping

- ▶ Only use the Clipper corded when the battery is empty.
- ▶ Clipper does not recharge during corded clipping.

- 1** Connect cord provided to clipper and plug clipper into electrical outlet (fig. 1).
- 2** If battery is completely empty, wait a few minutes before switching clipper ON.
- 3** Slide ON/OFF switch ON to begin clipping.
- 4** Turn clipper OFF and unplug.

Cordless Hair Clipping

- 1** Charge according to directions. Unplug Clipper from outlet and remove cord.
- 2** Slide ON/OFF switch ON to begin clipping.
- 3** If the charge runs out while clipping, simply connect cord provided to Clipper and outlet to continue clipping.

Hair Clipping

- ▶ Use this Clipper for its intended household use as described in this manual.
- ▶ Make sure that the appliance is fully charged before you start clipping hair.
- ▶ Before you start clipping, make sure that the head of the person whose hair you are cutting is at the same level as your chest so that all parts of his/her head are clearly visible and within easy reach.
- ▶ Only use the appliance on clean, dry hair.
- ▶ Do not use on freshly washed hair.
- ▶ Before you begin, comb the hair in the direction of growth (fig. 3).
- ▶ To achieve optimal clipping results, always move the appliance slowly through the hair against the direction of hair growth.

Clipping with small or large comb

- 1** Be certain the Clipper is in the OFF position.
- 2** Select the comb attachment. The table shows the remaining hair length after clipping at the different settings of the small or large comb.
- 3** Slide the selected comb into the guiding grooves on both sides of Clipper and push until you hear it 'click' into place (fig. 4).
- 4** Press the Hair Length Selector (1) and slide it to the desired setting (2) (fig. 5). See Table 1 for settings.
- 5** The setting indications on the comb show the selected setting.

When you are clipping for the first time, start at the maximum clipping length setting (#7) to familiarize yourself with the appliance and prevent accidentally trimming hairs too short. As you become familiar with the settings, adjust the Hair Length Selector to desired trimming length.

- 6** Make sure that the flat part of the comb is always in full contact with the scalp to obtain an even result.
- 7** Since all hairs do not grow in the same direction, move the appliance slowly over the crown from different directions (i.e. upwards, downwards and across) to achieve an even result (fig. 6).
- 8** Always move the appliance against the direction of hair growth.
- 9** Make overlapping passes over the head to ensure that all hair that should be cut has been cut.
- 10** For best results with curly, sparse or long hair, use a styling comb to guide the hair towards the Clipper.
- 11** Turn the Clipper off regularly during clipping and remove the hair comb to blow and/or shake out hair that has accumulated.

▶ **REMEMBER:** You must reset the hair length selector back to your desired setting every time you replace the hair clipping comb on the appliance.

TIP: Write down the settings you have used to create a certain hairstyle as a reminder for future clipping sessions.

Table 1. Small and Large Combs

Setting	Hair length after clipping with small comb	Hair length after clipping with large comb
1	1/8 in./3mm	23/25 in./23mm
2	1/4 in./6mm	1 ¹ / ₂₅ in./26mm
3	3/8 in./9mm	1 ⁴ / ₂₅ in./29mm
4	12/25 in./12mm	1 ⁷ / ₂₅ in./32mm
5	5/8 in./15mm	1 ² / ₅ in./35mm
6	18/25 in./18mm	1 ¹ / ₂ in./38mm
7	7/8 in./21mm	1 ¹⁶ / ₂₅ in./41mm

Clipping for a 'Stubble' Look

- ▶ To create a 'stubble' look clip with the small comb in setting 1, then clip with the stubble comb for a remaining hair length of .06 in/1.6 mm.
- 1** Be certain the Clipper is in the OFF position.
- 2** Slide the small comb into the guiding grooves on both sides of Clipper and push until you hear it "click" into place.
- 3** Press the Hair Length Selector and slide it to setting 1 (.12 in/3 mm).
- 4** Turn Clipper ON and clip hair making overlapping passes over the head to ensure all hair has been cut.
- 5** Turn Clipper OFF and remove small comb.
- 6** Put the stubble comb on the Clipper.
- 7** Turn Clipper ON and clip hair.

Contouring without a comb attachment

- 1** Remove the hair comb by pressing and sliding the Hair Length Selector upwards (fig. 7).
Be careful when you are clipping without comb attachment as when the Clipper is turned on it will remove every hair it touches.
- 2** To contour the hairline around the ears, comb the hair ends over the ears.
- 3** Tilt the Clipper in such a way that only one edge of the cutter blades touches the hair ends when you shape the contours around the ears (fig. 8).
Only cut the hair ends. The hairline should be close to the ear.
- 4** To contour the nape of the neck or sideburns, turn the Clipper and hold it with the cutter blades pointing downwards (fig. 9).
- 5** Move the Clipper slowly and smoothly following the natural hairline.

Cleaning

- ▶ Clean the attachments after each use.
- ▶ Always switch Clipper OFF, unplug and remove power supply cord from Clipper before cleaning.
- ▶ Do not use compressed air, abrasive cleaning agents, scourers or liquids such as alcohol, benzene, bleach or acetone to clean the Clipper and attachments.
- ▶ Never clean, replace or remove Clipper attachments with motor ON.
- ▶ Never rinse or immerse the Clipper handle in water or any other liquid.
- ▶ Do not apply pressure to cutters.
- ▶ Do not touch cutters with hard objects as this may damage them.
- ▶ Use a soft, dry cloth to clean Clipper handle.

During Use:

- ▶ If cut hairs have accumulated in the comb area, remove hairs by shaking, blowing or using cleaning brush provided. Remember to adjust the clipping length back to your selected setting when you replace the comb on Clipper.

After Each Use:

- 1** Make sure the Clipper is switched OFF and disconnected from the electrical outlet.
- 2** Remove any comb attachment.
- 3** The clipping attachment can be rinsed under the tap (fig. 10).
Always remove the clipping attachment from the handle before cleaning under the tap.
- 4** Turn the clipping attachment counter clockwise until the open dot on the handle aligns with arrow on the clipping attachment (1). Lift the clipping attachment off the handle (2) (fig. 11).
- 5** Blow and/or shake out any hair that may have accumulated in the attachment.
- 6** Push the center top end of the cutter blade upwards with your thumb until it opens and then pull it off the appliance (fig. 12).
Be careful that the cutter blade does not fall to the floor.
- 7** Rinse the cutter blade with warm water.
- 8** Clean the clipping attachment under warm water to flush out the cut hair that has accumulated in the attachment (fig. 13).
- 9** Let the cutter blade and clipping attachment dry completely before you reassemble the appliance.

Note: Make sure the electrical contacts of the clipping attachment are dry before you reattach the attachment to the handle.

- 10** When the cutter blade and the clipping attachment are dry, place the lug of the cutter blade in the slot of the clipping attachment. Then push the cutter blade back onto the clipping attachment (fig. 14).
- 11** Clean the handle and the adapter with the cleaning brush supplied or with a dry cloth.

Note: The handle and the adapter are not water-resistant.

- 12** To attach the clipping attachment, put it on the handle in such a way that the open dot on the handle is aligned with the arrow on the clipping attachment (1). Then turn the clipping attachment clockwise until the arrow aligns with the solid dot on the handle (2) (fig. 15).

This Clipper has no other user-serviceable parts. For assistance call 1-800-243-3050.

Assistance

For assistance, call toll free:

1-800-243-3050

or visit our website:

www.philips.com/norelco

Information is available 24 hours a day,
7 days a week.

Storage

- ▶ Be sure Clipper is turned OFF. Remove cord from outlet and Clipper before storing in a safe, dry location where it will not be crushed, banged, or subject to damage.
- ▶ Do not wrap cord around Clipper when storing.
- ▶ Store cord in a safe location where it will not be cut or damaged.
- ▶ Do not place or store Clipper where it can fall or be pulled into a tub or sink, water or other liquid while plugged in.

Battery Removal

- ▶ This Philips Norelco Clipper contains rechargeable Nickel Metal Hydride batteries which must be disposed of properly (fig. 16).
- ▶ Batteries should only be removed when Clipper is to be discarded.
- ▶ For assistance, call toll free: 1-800-243-3050 or visit our website, www.philips.com/norelco.

- 1** Unplug electrical cord from outlet and Clipper before dismantling Clipper.
- 2** Allow Clipper to run until the battery is empty/depleted.
- 3** Turn Clipper OFF.
- 4** Remove any comb and clipping attachment from the handle.
- 5** Use a screwdriver to remove the screw from the handle (fig. 17).
- 6** Pull the two panels off the handle (fig. 18).
- 7** Lift the batteries out of the handle (fig. 19).
- 8** Cut the wires close to the batteries with household scissors (fig. 20).
- 9** Do not attempt to replace batteries. Insulate battery ends by covering with tape and/or place batteries in a small plastic bag.
- 10** Discard your Clipper. Do not attempt to plug electrical cord into the outlet or recharge the Clipper after the batteries have been removed.
- 11** Contact your local town or city officials for battery disposal information or call 1-800-8-BATTERY or www.rbrcc.com for battery drop-off locations.

Full Two-Year Warranty

Philips Electronics North America Corporation warrants each new Philips Norelco product, Model QC5055 against defects in materials or workmanship for a period of two years from the date of purchase, and agrees to repair or replace any defective product without charge.

IMPORTANT: This warranty does not cover damage resulting from accident, misuse or abuse, lack of reasonable care, the affixing of any attachment not provided with the product or loss of parts or subjecting the product to any but the specific voltage.* Use of unauthorized replacement parts will void this warranty.

PHILIPS ELECTRONICS NORTH AMERICA CORPORATION WILL NOT PAY FOR WARRANTY SERVICE PERFORMED BY A NON-AUTHORIZED REPAIR SERVICE AND WILL NOT REIMBURSE THE CONSUMER FOR DAMAGE RESULTING FROM WARRANTY SERVICE PERFORMED BY A NON-AUTHORIZED REPAIR SERVICE.

NO RESPONSIBILITY IS ASSUMED FOR ANY SPECIAL, INCIDENTAL OR CONSEQUENTIAL DAMAGES.

In order to obtain warranty service, simply go to www.philips.com/norelco or call 1-800-243-3050 for assistance. It is suggested that for your protection you return shipments of product by insured mail, insurance prepaid. Damage occurring during shipment is not covered by this warranty. **NOTE:** No other warranty, written or oral, is authorized by Philips Electronics North America Corporation. This warranty gives you specific legal rights, and you may also have other rights which vary from state to state. Some states do not allow the exclusion or limitation of incidental or consequential damages, so the above exclusion and limitations may not apply to you.

*Read enclosed instructions carefully.

Manufactured for:

Philips Consumer Lifestyle

A Division of Philips Electronics North America Corporation

1600 Summer Street – 5th Floor, Stamford, CT 06905-5125



This symbol on the product's nameplate means it is listed by Underwriters' Laboratories, Inc.

Norelco is a Registered Trademark of Philips Electronics North America Corporation.

PHILIPS is a Registered Trademark of Koninklijke Philips Electronics N.V.

© 2009 Philips Electronics North America Corporation. All Rights Reserved.

4222 002 8027 3

PHILIPS

NORELCO

45-DAY MONEY-BACK GUARANTEE

If you are not fully satisfied with your Philips Norelco Hair Clipper, send the product back along with dated sales receipt and we'll refund you the full purchase price.

The Clipper must be shipped prepaid by insured mail, insurance prepaid, and have the original sales receipt, indicating purchase price and the date of purchase, enclosed. We cannot be responsible for lost mail.

The Clipper must be postmarked no later than 45 days after the date of purchase.

Philips Norelco reserves the right to verify the purchase price of the Clipper and limit refunds not to exceed suggested retail price.

To obtain Money-Back Guarantee Return Authorization Form, call 1-800-243-3050 for assistance. Please allow 4-6 weeks for delivery of check.